

**PART-II****INFORMATION IN RESPECT OF PROPERTY OWNERS OF THE UNAUTHORISED COLONY (TO BE PROVIDED BY RESIDENT WELFARE ASSOCIATION)**

**NAME AND ADDRESS OF COLONY:** Ishwer colony Ext. PHASE I & II Left out portion Kanjhawla road Bawana Delhi-110039.

**NAME OF RESIDENT WELFARE ASSOCIATION:** Jan Sewak Sudhar Samiti

Name of Property Owner	Father's/ Husband's Name	Plot No./ House No.	Whether Plot/Flat	Telephone No.. if any	Water (Yes/No.)	Electricity Connection (Yes/No)	Whether Member Of RWA Society (Yes/No)
Gulab Singh	Sh.Ram Saroop		House	No	No	No	Yes
Ram Singh	Sh.Ram Saroop		House	No	No	No	Yes
Surender Singh	Sh.Ram Saroop		House	No	No	No	Yes
Anand Singh	Sh.Ram Saroop		House	No	No	No	Yes
Aman Singh	Sh.Jiya Ram		House	No	No	No	Yes
Hari Prakash	Sh.Jiya Ram		House	No	No	No	Yes
Vinay Kumar	Sh.Jiya Ram		House	No	No	No	Yes
Parveen Kumar	Gulab Singh		House	No	No	No	Yes
Sandeep Kumar	Gulab Singh		House	No	No	No	Yes
Pawan Kumar	Ram Singh		Plot	No	No	No	Yes
Tarun Kumar	Surender Singh		Plot	No	No	No	Yes
Pardeep Kumar	Ram Singh		Plot	No	No	No	Yes
Anuj Kumar	Aman Singh		Plot	No	No	No	Yes
Aryan	Vinay Kumar		Plot	No	No	No	Yes
Vikas	Hari Prakash		House	No	No	No	Yes
Neeraj	Aman Singh		House	No	No	No	Yes
Rachit Kumar	Pawan Kumar		House	No	No	No	Yes
Ayush	Parveen Kumar		House	No	No	No	Yes
Riya	Pawan Kumar		Plot	No	No	No	Yes
Saruti	Hari Prakash		Plot	No	No	No	Yes
Nitika	Parveen Kumar		Plot	No	No	No	Yes

**Name & Signature**  
1: President/secretary

**President**  
**Resident Welfare Association**  
**(Jan Sewak Sudhar Samiti)**  
Ishwer Colony Extn  
New Delhi

IN WITNESS WHEREOF this Indemnity Bond is executed by the  
Executant on the date, month and year first above written in present  
of the following witnesses :-



WITNESSES:

1. 

2. 

  
EXECUTANT



13 JAN 2008



E 191168

### INDEMNITY BOND

This Indemnity Bond is made this 23<sup>rd</sup> day of January, 2008 by Ram Singh, President, Ishwar Colony Extension, Phase-I, II, Left Out Portion, Kanjhawala Road, Bawana, Delhi-110039, I, do hereby indemnify as under :-

1. That I am submitting lay out plan of Ishwar Colony Extension, Phase-I, II, Left Out Portion, Kanjhawala Road, Bawana, Delhi-110039 on behalf of our Association for sanction.
2. That I am giving an undertaking on behalf of our association that Govt. of NCT of Delhi will not be liable for any loss or damages from natural hazards based on soil conditions to our colony.



- 2 -

5. That I am not liable to give the undertaking that the vacant land would be transferred in the name of DDA/MCD.
6. That the RWA shall surrender the land in favour of DDA/MCD free of costs in order to provide for roads or drainage in conformity as the planning/development control norms.

  
  
**DEPONENT**

**VERIFICATION:**

Verified at Delhi on this the 23<sup>rd</sup> day of January, 2008 that the contents of above affidavit are true to my knowledge, no part of it is false and nothing has been concealed therefrom.

  
**DEPONENT**

**ATTESTED**  
  
**NOTARY PUBLIC**  
**DELHI (INDIA)**

**23 JAN 2008**

भारतीय गैर न्यायिक

दस  
रुपये  
रु.10

TEN  
RUPEES

Rs.10

INDIA

INDIA NON JUDICIAL



**AFFIDAVIT**

15AA 423807

I, Ram Singh, President, Ishwar Colony Extension, Phase-I, II, Left Out Portion, Kanjhawala Road, Bawana, Delhi-110039, do hereby solemnly affirm and declare as under:-

1. That the above said association registered under Registration No. 15926 C.T.P. dated 26<sup>th</sup> July, 2002.
2. That I am submitting the required lay out plans of Ishwar Colony Extension, Phase-I, II, Left Out Portion, Kanjhawala Road, Bawana, Delhi-110039 for sanction drawn to a scale of 1:1000 prepared by the Architect, Town Planner registered with the council of Architects.
3. The association ready to pay necessary charges for Electricity, Water, Sewer, Drainage Etc. to the concerned authority/Department.
4. That no vacant land is available in our colony for community centre, park or other activities.

..2/- contd.

*(Signature)*

# LAY OUT PLAN OF ISHWAR COLONY KANJHAWALA ROAD, BAWANA NEW DELHI - 39

TOTAL AREA - 1.00 ACS.

TOTAL PLOTS -

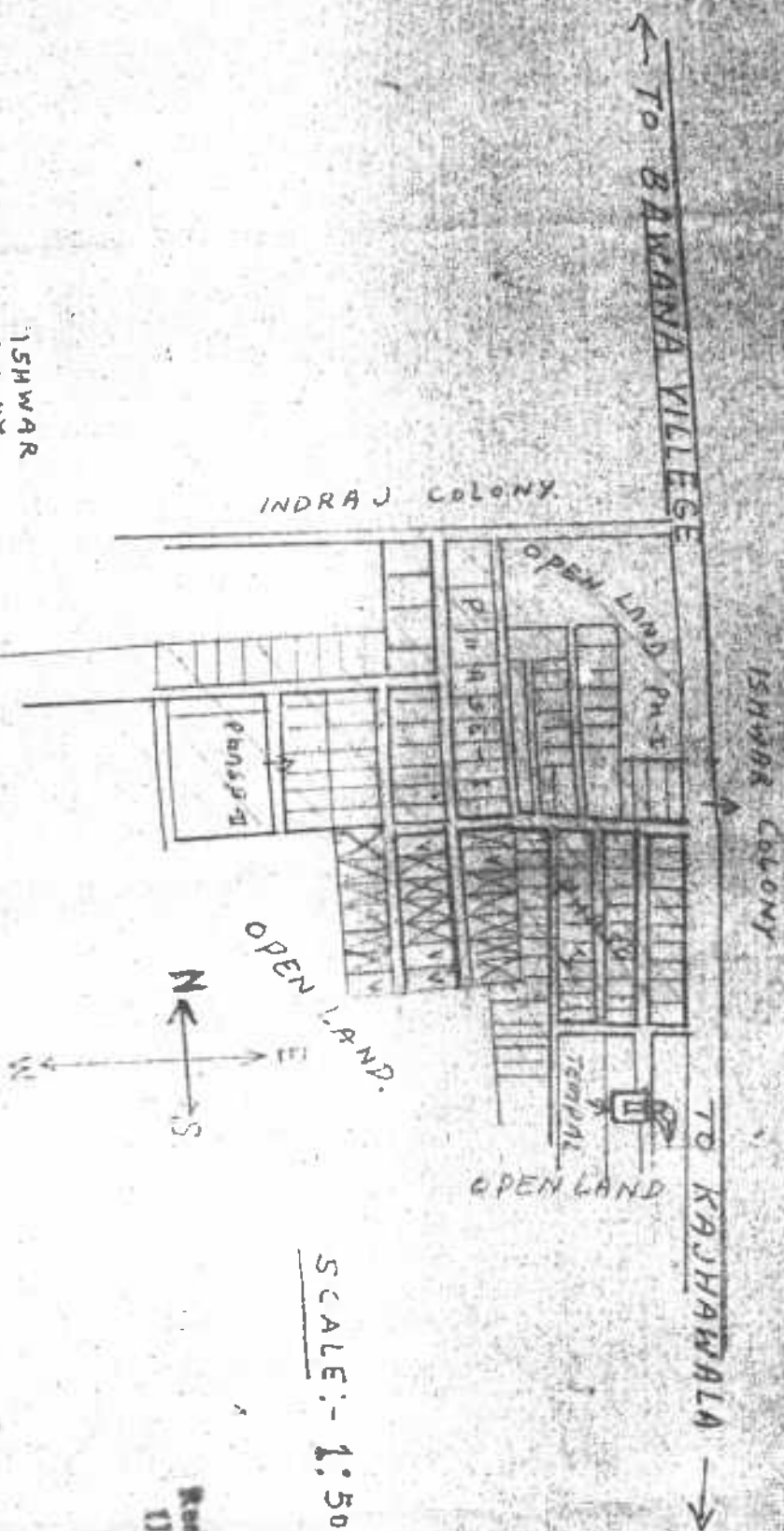

SCALE:- 1:5000

**Resident Welfare Association**  
(Jan Sewak Sushar Samiti)  
Lower Colony Extra  
New Delhi

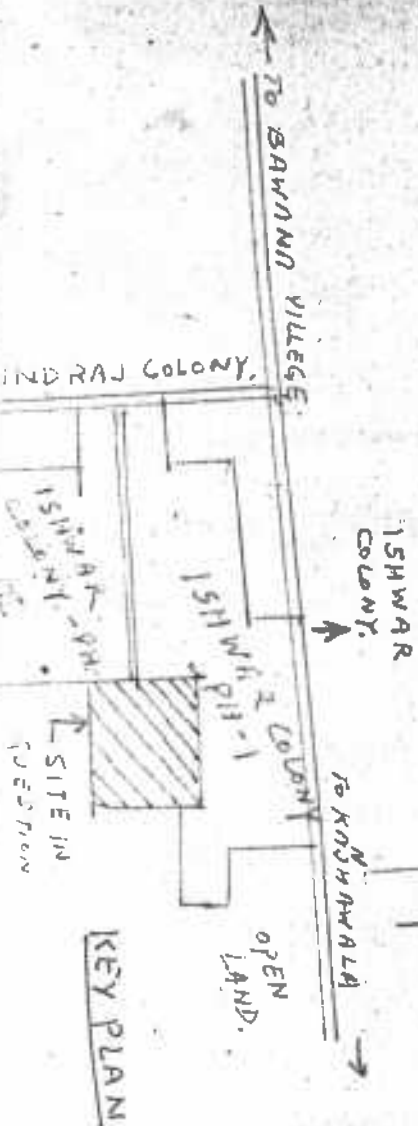

**Resident Welfare Association**  
(Jan Sewak Sushar Samiti)  
Lower Colony Extra  
New Delhi

**R.S. YADAV & ASSOCIATES**  
Architects, Engineers & Valuers  
Regd. Lic. No. S-1106  
Off. Ch. No. 61, Typist Block  
Civil Side, Tia Hazari Courts  
Delhi-110054  
Ph: (O) 23940864, (R) 56078254  
M. 9810725241, 9213534855

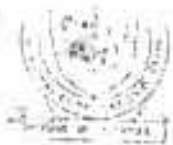

117/5TH (CP) पापंद  
दिल्ली नगर निगम  
नं. ४२

15926/CTP

26/7/02

The Chief Town Planner,  
Town planning Deptt.

Municipal Corporation Delhi  
Kashmiri Gate Delhi.

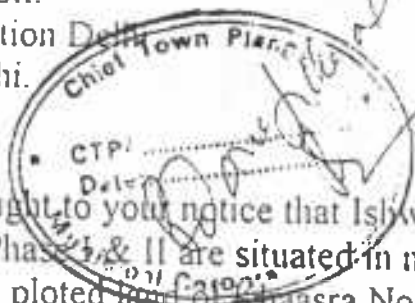

It is being brought to your notice that Ishwar Colony Extension Phase I & II are situated in my constituency. Some plotted land at Khasra No. 158/1, which is surrounded by these two populated phases was left to be included in the colony maps of the time of survey. So this Khasra No. 158/1, be included in the maps of the above mentioned extension phases now.

The above mentioned Ishwar Colony is situated in village Barwana, Delhi-110039.

Record File No

17/16 dt 27/02

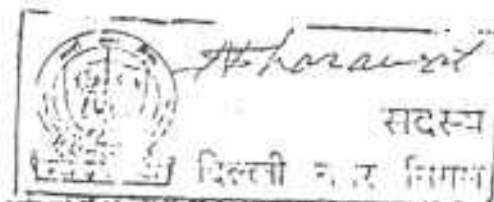

**President**  
Resident Welfare Association  
(Jan Sewak Sudhar Samiti)  
Ishwar Colony Extn  
New Delhi-110039



**Residents Welfare Association  
(Jan sewak sudhar samiti)  
Ishwer colony, Ext. Phase I & II Left Out Portion  
Kanjhawla Road, Bawana Delhi-39.**

Ref.....

Res: Ram Singh-589.

Village & post Office Bawana,  
Mohalla Begwan, Delhi-110039.

160148

27752906

Principal Secretary(U.D.)  
New Secretariate (I.T.O.)  
I-P Estate Vikas Marg.

Sub. Left out portion of Ishwer colony Ext. Phase 1<sup>st</sup> & 2<sup>nd</sup>  
Kanjhawla Road Bawana Delhi-39.

Some plotted land of Khasra No. 158/1 left out of the map of the above said colony and the file is under consideration in the office of the chief town planner Kashmere gate Delhi Vide diary No. 15926/C.T.-P (02) 26-07-2002 and colony record file No. 17/167 dated 27-07-2002.

As per fresh demand of maps of all colonies the files were deposited at New Secretariate (I.T.O.) in Dec. 2004 but the file of said case unknowing could not be deposited there. So, this file may also be received and considered now.

Thanks,

  
President  
Resident Welfare Association  
(Jan Sewak Sudhar Samiti)  
Ishwer Colony Extn.  
New Delhi

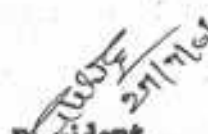
  
President  
Resident Welfare Association  
(Jan Sewak Sudhar Samiti)  
Ishwer Colony Extn. Bawana  
New Delhi-110039



**Surender Kumar**  
M.L.A.  
DELHI LEGISLATIVE ASSEMBLY



H. No. 795, VII. & Post Office  
Bawana, Delhi-110039  
Telephone : 27752200

दिनांक 30-6-2006

श्री मनोज कुमार जी,

मैं आपके पास बवाना ईश्वर कालोनी, फेस-2 का प्रतिवेदन संलग्न कर भेज रहा हूँ। इस कालोनी के साथ खसरा नं. 158/1 है। जिसको कालोनी के साथ जुड़वाना चाहते हैं।

मेरा आपसे अनुरोध है कृपया इस संदर्भ में उचित कार्रवाई करने का कष्ट करें।

धन्यवाद

आपका

  
(सुरेन्द्र कुमार)

श्री मनोज कुमार जी,  
संयुक्त सचिव, (यूडी)  
शहरी विकास विभाग,  
दिल्ली सरकार

  
**Resident Welfare Association**  
(Jan Sewak Sudhar Samiti)  
Lower Colony Extra  
New Delhi-110039

**Residents Welfare Association  
(Jan sewak sudhar samiti)  
Ishwer colony, Ext. Phase I & II Left Out Portion  
Kanjhawla Road Bawana Delhi-39.**

Ref.....

Res: Ram Singh-589.  
Village & post Office Bawana,  
Moholla Begwan, Delhi-110039.

M.L.A.

Bawana constituency.

Sub. Left out portion of Ishwer colony Ext. Phase 1<sup>st</sup> & 2<sup>nd</sup>  
Kanjhawla Road Bawana Delhi-39.

Some plotted land of Khasra No. 158/1 left out of the map of the above colony and the file under consideration in the office of the chief town planner Kashmere gate Delhi Vide diary No. 15926/C.T.-P (02) 26-07-2002 and colony record file No. 17/167 dated 27-07-2002.

As per fresh demand of maps of all colonies the files were deposited at New Secretariate (I.T.O.) in Dec. 2004 but the file of said case unknowing could not be deposited there. So, you are requested to help in depositing this file now for consideration with the old files.

Thanks,

  
**President**  
**Resident Welfare Association**  
**(Jan Sewak Sudhar Samiti)**  
Lower Colony Extn  
New Delhi - 110039

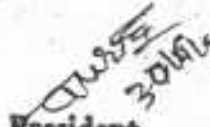
  
**President**  
**Resident Welfare Association**  
**(Jan Sewak Sudhar Samiti)**  
Lower Colony Extn. Bawana  
New Delhi-110039

**RESIDENTS WELFARE ASSOCIATION  
(JAN SEWAK SUDHAR SAMITI)  
ISHWAR COLONY EXT., PHASE I & II, LEFT OUT PORTION  
KANJHAWALA ROAD, BAWANA, DELHI-39**

Ref.

Dated

**UNDERTAKING**

Ishwar Colony Extension, Phase-I, II, Left Out Portion, Kanjhawala Road, Bawana, Delhi-110039 give its following undertaking in connection with the Regularization of unauthorized colonies as required vide Delhi Published in Sunday Nav Bharat Times dated 4.11.2007 :-

- (a) The Samiti is entirely agree with the Lay Out Plan and its proposed civic facilities of Ishwar Colony Extension, Phase-I, II, Left Out Portion, Kanjhawala Road, Bawana, Delhi-110039.
- (b) The Samiti undertake to pay all development charges i.e. Electricity, Water, Drainages, Sewerage, and other related charges. Ram Singh, President of Ishwar Colony Extension, Phase-I, II, Left Out Portion, Kanjhawala Road, Bawana, Delhi-110039 President is hereby authorizes to deal with all related case.
- (c) The Samiti is abide to provide Land Free of cost to the concerned Department for give facilities.

  
Hari Prakash  
(Secretary)

  
Sh. Ram Singh  
(President)

**President**  
**Resident Welfare Association**  
**(Jan Sewak Sudhar Samiti)**  
Ishwar Colony Extn.  
New Delhi-110039

**RESIDENTS WELFARE ASSOCIATION  
(JAN SEWAK SUDHAR SAMITI)  
ISHWAR COLONY EXT., PHASE I & II, LEFT OUT PORTION  
KANJHAWALA ROAD, BAWANA, DELHI-39**

Ref.

Dated

**EXTRACT OF THE RESOLUTION PASSED IN THE MEETING OF  
Ishwar Colony Extension, Phase-I, II, Left Out Portion, Kanjhawala  
Road, Bawana, Delhi-110039 HELD ON 11<sup>TH</sup> NOVEMBER, 2007.**

A Meeting of Executive Committee was held on 11.11.2007 at 9.00 A.M. at Ishwar Colony Extension, Phase-I, II, Left Out Portion, Kanjhawala Road, Bawana, Delhi-110039. The meeting was chaired by the President and the following members were present:-

1.	Ram Singh	President
2..	Hari Prakash	Secretary, Treasurer
3.	Ram Singh	Member
4.	Gulab Singh	Member
5.	Surender Kumar	member
6.	Anand Singh	Member
7.	Aman Singh	Member
8.	Vinay Kumar	Member
9.	Parveen Kumar	Member
10.	Pawan Kumar	Member

**AGENDA: Regularization of unauthorized colony Ishwar Colony Extension, Phase-I, II, Left Out Portion, Kanjhawala Road, Bawana, Delhi-110039.**

The members got information through Govt. of NCT of Delhi notification published in News Papers on 4.11.2007 that Govt. of NCT of Delhi is processing the regularization of unauthorized colonies, which have already being notified in the list of colonies for approval.

It was therefore unanimously resolved that Ram Singh, President of Ishwar Colony Extension, Phase-I, II, Left Out Portion, Kanjhawala Road, Bawana, Delhi-110039 of the Samiti is hereby authorized to sign, verify, file affidavit and other related documents required in processing the regularization of unauthorized colony Ishwar Colony Extension, Phase-I, II, Left Out Portion, Kanjhawala Road, Bawana, Delhi-110039. He is authorized to deal all correspondence and file reply on the related matter.

Meeting ended with thanks to Chair.

  
Hari Prakash  
(Secretary)

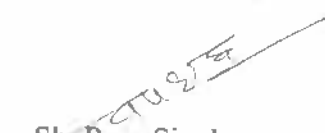
  
Sh. Ram Singh  
(President)  
**President**  
**Resident Welfare Association**  
**(Jan Sewak Sudhar Samiti)**  
Ishwar Colony Extn,  
New Delhi-110039

**RESIDENTS WELFARE ASSOCIATION  
(JAN SEWAK SUDHAR SAMITI)  
ISHWAR COLONY EXT., PHASE I & II, LEFT OUT PORTION  
KANJHAWALA ROAD, BAWANA, DELHI-39**

Ref.

Dated

**UNDERTAKING**

Certified that our Association will be  
abided by the rules and regulations  
prescribed by the Government.

  
**President**  
**Resident Welfare Association**  
**(Jan Sewak Sudhar Samiti)**  
Isar Colony Extn  
New Delhi-110008

30.	Status of Services	Nos./Area/ Width/Length	Stage of Development
	Roads	20 Feet Wide Length - 440 Feet	
	Water Supply	NO	
	Hand Pumps	YES	
	Tube Wells	NO	
	Underground Water Tank	NO	
	Street Light	NO	
	ESS/Transformer/Generators	NO	
	Drains	NO	
	Sewerage/Sanitation	NO	
	Fire Fighting installations	NO	
31.	Status of Facilities	Nos./Area/ Width/Length	Stage of Development
	Park/Transport lots/Common	NIL	
	Open Space	NIL	
	Schools	NIL	
	Community Hall	NIL	
	Common parking areas	NIL	
	Dispensary/Health Centre	NIL	
	Religious structures	NIL	
	Police Post/Fire Post	NIL	

**Enclosures:**

- Resolution of the Resident Society
- Registration Certificate of Society with authenticated list of members/owners/occupants
- Existing Survey (05 copies + CD)
- Regularization Plans/5 Lay Out Plan (Service Plan (05copies + CD)
- Certificate/documents/NOCs as mentioned

Signature of Authorised Signatory  
Resident Society

**President**  
**Resident Welfare Association**  
(Jan Sewak Sudhar Samiti)  
Lower Colony Extn  
New Delhi - 110017

19.	List of members with Plot/Property No.(to be attached)	Attached
20.	Percentage of Residents/house Owners as members of the Resident Society	60 %

21. No. of Built-up Plots :- (Min.35% of Gr. Floor permissible coverage)

- (i) Upto 100 sq. mtrs .             
(ii) Above 100 sq.mtrs. .     12      
(iii) Above 250 sq. mtrs. .

22. No. of Vacant Plots:

- (i) Upto 100 sq. mtrs .             
(ii) Above 100 sq.mtrs. .     9      
(iii) Above 250 sq. mtrs. .

23.	Land use: As per Master Plan As per Zonal Plan		
24.	Whether falls in Reserved Forests or Regional Park	/	/
25.	Whether the colony effects/falls over  Master Plan Road alignment Railway Line Metro Corridor Water Supply/swerage lines/Utilities Works	/	/
26.	Any Monuments/Heritage Buildings in the Colony or in the vicinity	/	/
27.	Key Plan/Site Plan of unauthorized colony and Description of boundaries.....  (Please attach scaled Key Plan/Plan of Colony Superimposed on Zonal Plan/City Survey Map Indicating North Point, surrounding features, Adjacent roads, buildings, drains, electricities,lines Etc.)	Attached  Attached	
28.	NOC as mentioned at para iv (ii): (please attach)		
29.	Undertaking/Indemnity Bond (please attach)	Attached	

*Prasanna*  
**President**  
**Resident Welfare Association**  
**(Jan Sewak Sudhar Samithi)**  
 Lower Colony Extn  
 New Delhi - 110028



**APPLICATION & CHECK LIST FOR REGULARIZATION OF UNAUTHORISED COLONY**  
(To be filled up by the Resident Society and to be countersigned by Architect-Town Planner & service Engineer)

1.	Name and address of the colony	Eastwar Colony Ext PH-I & II Left out - Portion Kanjawala Road BAWANA - NEW DELHI-110039
2.	Regn. No. in the GNCTD list	01494
3.	Name of Resident Society	Jan Sewak Sudhar Samiti
4.	Registration No. of the Resident Society (with Registrar of Societies)	APPLIED FOR
5.	Name of physical Surveyor & Socio-economic Surveyor	Ashwani Kumar.
6.	Name of Services Engineer	C.K. Choudhary.
7.	Name of Supervising Engineer	- do -
8.	Name of Authorized Signatories	RAM. SINGH
9.	Category of colony (as notified Vide Public Notice dated 14.10.2007)	(G)
10.	Revenue Village	BAWANA - DELHI-110039
11.	Zone (As per Master Plan of Delhi)	M. C. D
12.	Date from which unauthorized Colony exists.	26th July 2002
13.	Location/surroundings (Towards North South, East, West)	East Eastwar Colony Ext. PH-I West OPEN Land. North Eastwar Colony Ext. PH-II South OPEN Land.
14.	Development Area No. Whether falls in Notified Slum Area	- NO -
15.	Total area of Unauthorised colony	1 - 4048 sq met. 2 - 01 - Acre
16.	Land Status/Ownership	Personal
17.	Court Case, if any (Please attach details)	-
18.	Land whether notified for acquisition	-

**President**  
**Resident Welfare Association**  
(Jan Sewak Sudhar Samiti)  
Eastwar Colony Ext.  
New Delhi-110039

**Residents Welfare Associaton  
(Jan Sewak Sudhar Samiti)  
Ishwer Colony, Ext. Phase I & II Left Out Portion  
Kanjhawla Road Bawana Delhi-39.**

Ref.....

Res: Ram Singh-589.  
Village & Post Office Bawana,  
Moholla Begwan, Delhi-110039.

DATED: 30th January, 2008.

To

The Department of Urban Development,  
Govt. of NCT of Delhi,  
9th Level, Delhi Sectt.,  
New Delhi.

Sir,

It is respectfully submitted as under :-

1. That the applicant is President of the Residents Welfare Association (Jan Sewak Sudhar Samiti), Ishwer Colony, Ext. Phase I and II Left out Portion, Kanjhawla Road Bawana, Delhi-39.
2. That we have applied for the Registration of the Society and as soon as we got the Registration No. we will inform you immediately.

Thanking you,

Yours faithfully

President

For Residents welfare Associ.  
~~President~~  
**Resident Welfare Association**  
**(Jan Sewak Sudhar Samiti)**  
Ishwer Colony Extn  
New Delhi-110039

**RESIDENTS WELFARE ASSOCIATION  
(JAN SEWAK SUDHAR SAMITI)  
ISHWAR COLONY EXT., PHASE I & II, LEFT OUT PORTION  
KANJHAWALA ROAD, BAWANA, DELHI-39**

Ref.

Dated

To,

**The Ministry of Urban Development,  
Government of N.C.T. of Delhi,  
Delhi Secretariat,  
I.P. Estate,  
NEW DELHI.**

Subject: Application for regularization (Sl. No.01494, Ishwar Colony Extension, Phase-I, II, Left Out Portion, Kanjhawala Road, Bawana, Delhi-110039) under the provision of Government notification dated 4.11.2007.

Sir,

An application for regularization of unauthorized colony (Serial No.01494, Ishwar Colony Extension, Phase-I, II, Left Out Portion, Kanjhawala Road, Bawana, Delhi-110039) is forwarded herewith alongwith the following documents for kind consideration please:-

- (a). Extract of resolution authorizing Sh. Ram Singh (President) and Hari Prakash (Secretary) to deal with the case.
- (b). Affidavit of Sh. Ram Singh (President).
- (c). Undertaking
- (d). Indemnity Bond.
- (e). Certificate from Architect.
- (f). Registration Certificate of the resident society.
- (g). Resolution/Construction of the resident Society.
- (h). List of the owners/Residents.
- (i). Existing Survey Plan + CD.
- (j). Layout plan on the scale of 1:1000 with key plan/site plan on 1:10000 scale.
- (k). Site Plan of 1:5000 plan.
- (l). Service Plan of 1:1000 plan with CD.

Please acknowledge receipt.

Thanking you,

  
**President**  
**Resident Welfare Association**  
**(Jan Sewak Sudhar Samiti)**

Ishwar Colony Extn  
New Delhi-110039

**Yours faithfully**

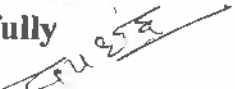
  
Sh. Ram Singh  
(President)

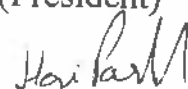
  
Hari Prakash  
(Secretary)



**CERTIFICATE OF REGISTRATION**  
**UNDER SOCIETIES REGISTRATION ACT OF XXI, 1860**

Registration No. SI 61752 /2008

I hereby certify that Serve Hitkarni Aram

Ve'kas Samiti Kanjhawla Road Bawana, Delhi-39

located at Plot No 12-13 Ishwar Colony Ext. Ph-II. (Lop)  
Bawana, Delhi-110039

\_\_\_\_\_ has been registered\* under  
**SOCIETIES REGISTRATION ACT OF 1860.**

Given under my hand at Delhi on this 28<sup>th</sup> day of  
March Two Thousand Eight.

Fee of Rs. 50/- Paid

Seal

Registrar of Societies  
Delhi

*Balwant Singh*  
(BALWANT SINGH)  
REGISTRAR OF SOCIETIES  
GOVT. OF NCT OF DELHI  
DELHI

\* This document certifies registration under the Society Registration Act 1860. However, any Govt. department or any other association or person may kindly make necessary verification (on their own) of the assets and liabilities of the society before entering into any contract/assignment.

*Serve Hitkarni Aram*  
Ishwar Colony Ext. Phase II  
Bawana, Delhi-110039

GOVERNMENT OF NCT OF DELHI  
URBAN DEVELOPMENT DEPARTMENT  
10<sup>TH</sup> LEVEL, DELHI SECRETARIAT,  
I.P. ESTATE NEW DELHI

F.No. 1535

Dated: 10/02/08

To

The President,

Jan Sewak Sudhar Samiti

Ishwar Colony Extn, Kanharia Rd.

Bawana, Delhi - 39.

**Sub: Verification of documents of unauthorized colonies for the purpose of regularization.**

Sir,

A preliminary scrutiny of the application submitted by the unauthorized colony and figuring at ~~serial~~ <sup>Regd.</sup> No. 1494 of the list of such unauthorized colony has been made. It has been noted that you have not submitted the following required documents, along with your application:-

**As per check list enclosed.**

You are therefore, requested to kindly get the registration of your resident society done immediately, if not already registered, with the Registrar of Societies GNCT of Delhi. A copy of the certificate along with other deficient documents as pointed out above may please be got ready as the government of NCT of Delhi proposes to hold a camp shortly for rectification of deficiencies in the application forms.

This is in pursuance of the decision to grant a provisional registration certificate. The date and time of the camp would be notified through public advertisement.

Yours faithfully,

(J.G. ARORA)

DY. SECRETARY (UC)

Encl: Check list.

## CHECK LIST OF DOCUMENTS

Name of Colony:- Ishwar Colony Extn. , Kanjharwade Rd.  
Regn./Sl. No.:- 1494 Bawana.

- Registration Certificate of Resident Society - No.
- Existing Layout Plan of the colony on the scale of 1:1000, prepared by an Architect/Town Planner signed by President/Secretary of the Resident Society. - yes
- Complete list of members with details such as plot Nos. and area of the colony - yes.
- Land status with Khasra No. accompanied by a site plan giving the physical description of the site - No
- Undertakings: - yes - but not different languages
  - i. That they shall abide by the layout plans as may be approved with or without conditions
  - ii. That they shall transfer the land available, if any for social infrastructure in the name of the DDA or the MCD/NDMC, free of cost, in order to provide such social infrastructure

  
13/8/08



GOVERNMENT OF NCT OF DELHI  
URBAN DEVELOPMENT DEPARTMENT  
10<sup>TH</sup> LEVEL, DELHI SECRETARIAT,  
I.P. ESTATE, NEW DELHI

F. No. 1-33/UC/UD/Policy/08/PFI

Dated: 14 AUG 2008

To,

The President / Secretary

ISHWAR Colony Extn.

Ph- IInd left out Portion

Kanjhalu Road, Bahana, Delhi- 39

Registration No. 1494

Sub: - Eligibility slip for issuance of Provisional Regularization Certificate.

Sir,

The documents submitted by you have been scrutinized and your unauthorized colony bearing Registration No. 1494 has been found eligible for issuance of Provisional Certificate of Regularization.

Checked  
14/8/08

Yours faithfully,

(Incharge)

Counter No.

Urban Development Deptt  
(Govt. of Delhi)  
Delhi Secretariat New Delhi - 2